

# LANDSCAPE PLAN - 1 of 3

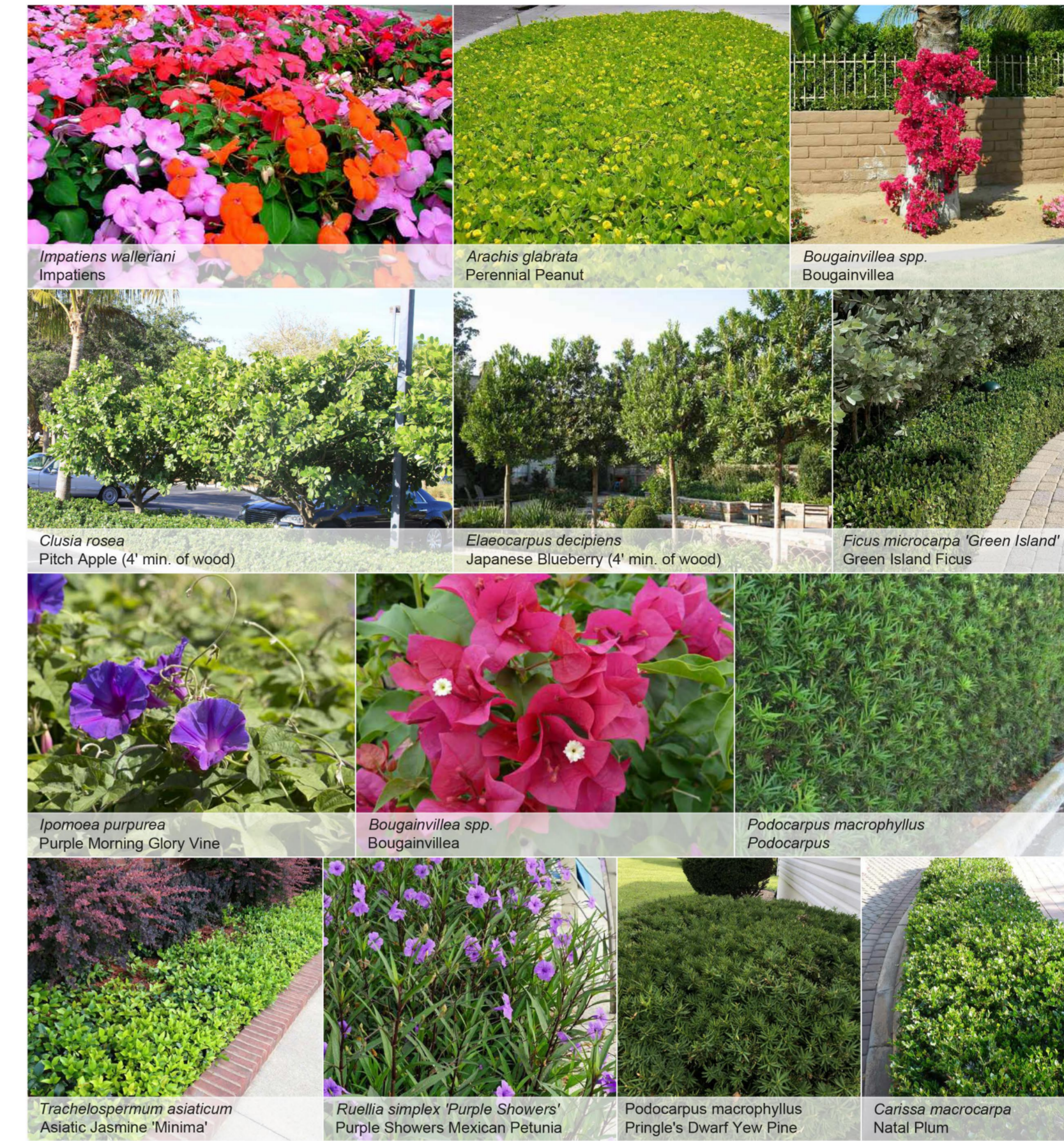

PLAN A - ENTRANCE PLAN

## PLANTING PALETTE



KEY PLAN - NOT TO SCALE

LEGEND				
Icon	Code	Name	Qty	Size
<b>Groundcover planting</b>				
	G1	<i>Arachis glabrata</i> Perennial Peanut	82 ft <sup>2</sup> , #23	4" flat
	G2	<i>Trachelospermum asiaticum</i> Asiatic Jasmine 'Minima'	1456 ft <sup>2</sup> , #420	4" flat
	G3	<i>Impatiens walleriana</i> Impatiens	341 ft <sup>2</sup> , #393	4" flat
	G4	<i>Ruellia simplex</i> 'Purple Showers' Purple Showers Mexican Petunia	313 ft <sup>2</sup> , #40	1 gal
<b>Shrub planting (in mulch)</b>				
	S1	<i>Bougainvillea</i> spp. Bougainvillea	#5	45 gal
	S2	<i>Ipomoea purpurea</i> Purple Morning Glory Vine	#8	7 gal
<b>Hedge planting</b>				
	HE1	<i>Carissa macrocarpa</i> Natal Plum	#216	3 gal
	HE2	<i>Podocarpus macrophyllus</i> 'Pringle's Dwarf' Pringle's Dwarf Yew Pine	#41	3 gal
	HE3	<i>Ficus microcarpa</i> 'Green Island' Green Island Ficus	#62	3 gal
	HE4	<i>Podocarpus macrophyllus</i> Podocarpus	#159	7 gal
<b>Lawn planting</b>				
	L1	Existing lawn to remain	-	-
	L2	St. Augustine Grass	457 ft <sup>2</sup>	-
<b>Trees</b>				
	T1	<i>Clusia rosea</i> Pitch Apple (4' min of wood)	#15	45 gal
	T2	<i>Eleocharis decipiens</i> Japanese Blueberry (4' min of wood)	#25	45 gal
	T3	Existing tree to remain	-	-
	T4	Existing Palm tree to remain	-	-
	T5	Trees to be removed of which 3 Ligustrum to be transplanted	#5	-
	T6	Ligustrum Trees transplanted	#3	-
<b>Hard landscape</b>				
	H1	Mulch	6179 ft <sup>2</sup>	-
	H2	Aluminum Pergola structure - 8" posts with 6" cross-members, powder-coated	#2; 36 Lft each	-
	H3	Trellis around existing palm trees for Bougainvillea to grow on	#5	25 gal
	H4	Optional edging	221 Lft	-

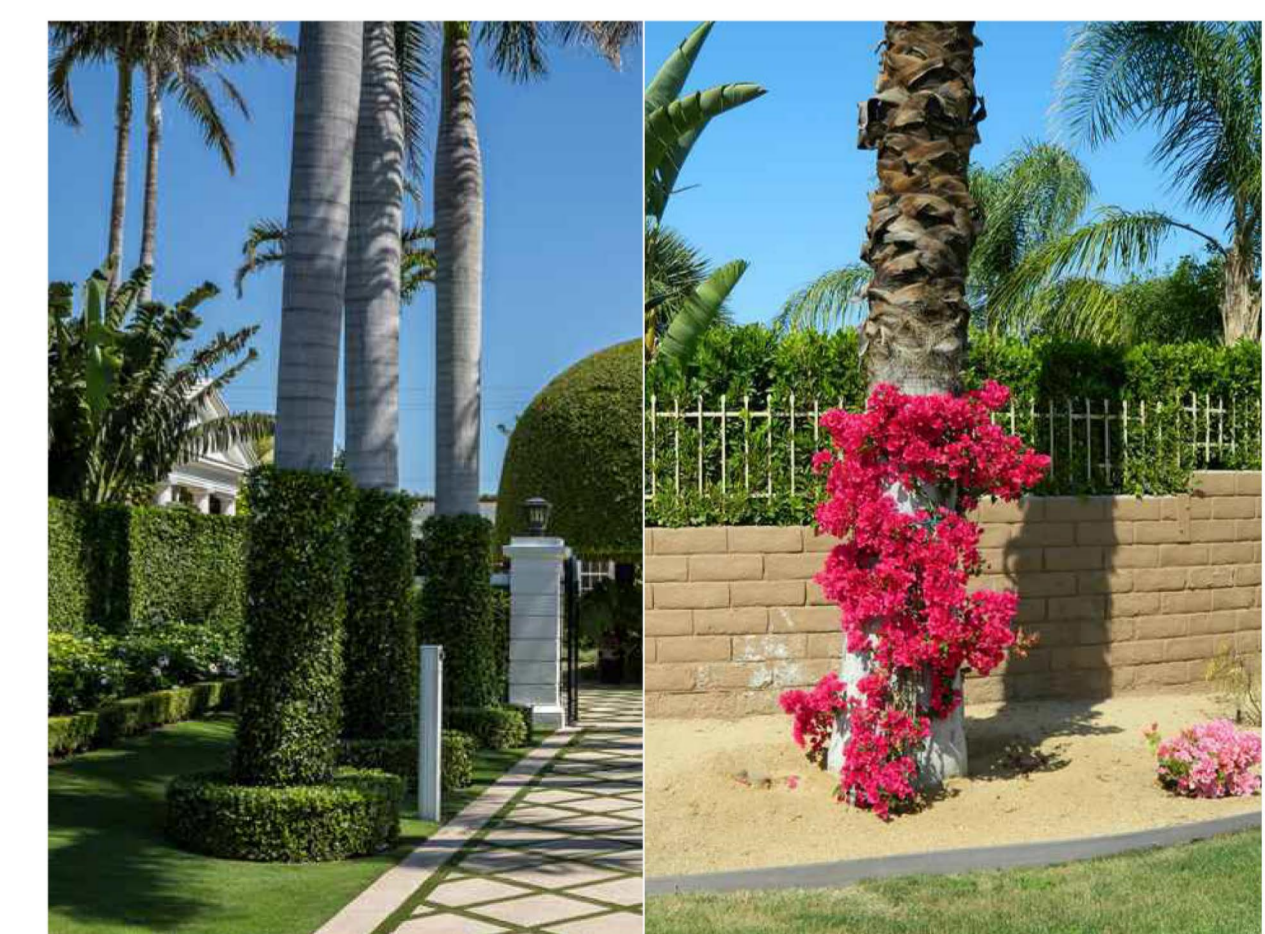

THEME IMAGES

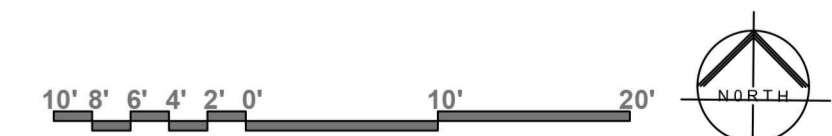

## ADDISON PROJECT - OPTION 1

10005 Royal Palm Blvd, Coral Springs, FL 33065 | 10-24-2023 | Scale 1"=10'-0" 24x36in |  
Designed by: BT | Author: LW | Checked: SR | Rev: 3 | Issued for client feedback

### COPYRIGHT NOTICE

© Copyright 2023. This drawing & design is subject to copyright. All rights reserved in terms of the United States Copyright Law. You may use, display, print and reproduce this drawing only for use on the project as described in the title block of this drawing. The author of this drawing & design is the copyright owner and it remains the property of the author. No parts of this drawing or design may be reproduced, published, transmitted or adapted in any way without the prior written permission of the copyright owner. Such permission, if granted, is subject to a fee depending on the nature of the use. Requests and inquiries regarding reproduction should be addressed to the Copyright Owner. Any unauthorized reproduction, publication, transmission, adaptation of this drawing or design is an act of copyright infringement which will render the doer of the act liable for civil law copyright infringement and may in certain circumstances render the doer liable to criminal prosecution.

### GENERAL NOTES

- All dimensions to be thoroughly checked on site and any or all discrepancies to be reported to the author of this drawing immediately before any work is put to hand.
- All work to be executed by competent persons qualified for the specific trade.
- Storm water management as per engineers design & specification.
- All structural and retaining elements to be designed & specified by engineer.
- Plant species may be substituted for a similar species, depending on availability at time of installation.

NO	DATE	REVISION
1	10-11-2023	DESIGN CHANGES
2	10-11-2023	DESIGN CHANGES
3	10-24-2023	PLANT CHANGES

PRINT NOTICE  
Ensure correct page size is selected. (Refer to file name for page size)  
To ensure correct scale, print "ACTUAL SIZE" do NOT select "FIT TO PAGE".



# LANDSCAPE PLAN - 2 of 3

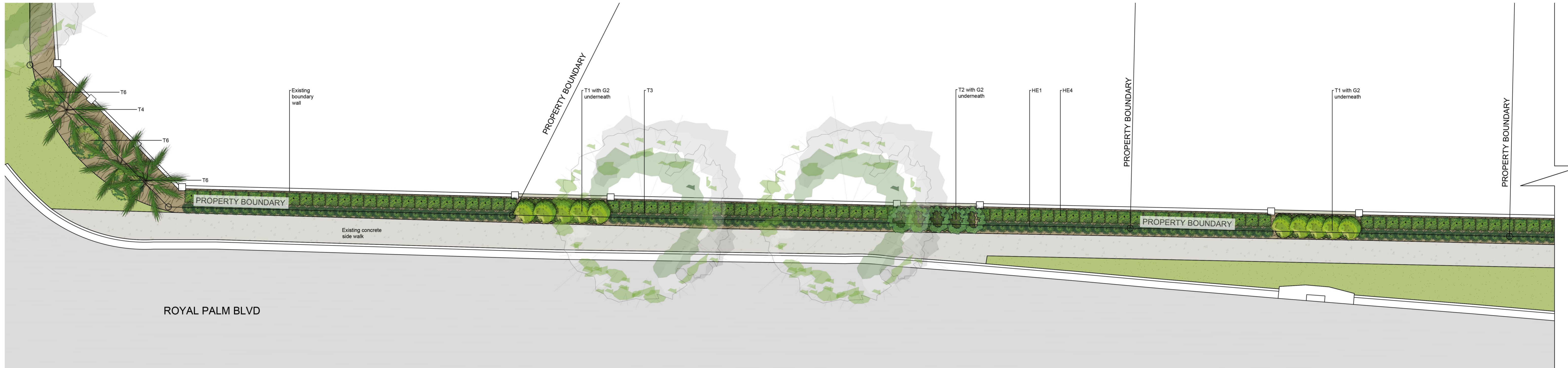

PLAN B - EAST SECTION 1

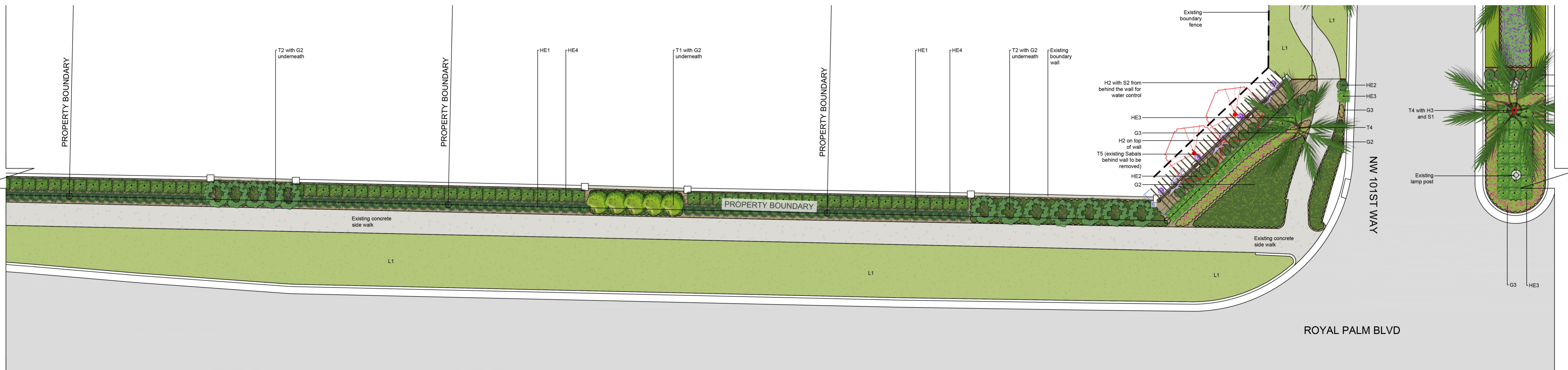

PLAN C - EAST SECTION 2

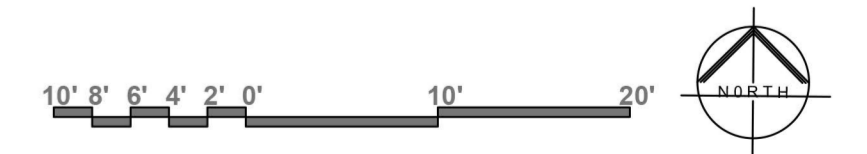

## ADDISON PROJECT - OPTION 1

10005 Royal Palm Blvd, Coral Springs, FL 33065 | 10-24-2023 | Scale 1"=10'-0" 24x36in |  
 Designed by: BT | Author: LW | Checked: SR | Rev: 3 | Issued for client feedback

**COPYRIGHT NOTICE**

© Copyright 2023. This drawing & design is subject to copyright. All rights reserved in terms of the United States Copyright Law. You may use, display, print and reproduce this drawing only for use on the project as described in the title block of this drawing. The author of this drawing & design is the copyright owner and it remains the property of the author. No parts of this drawing or design may be reproduced, published, transmitted or adapted in any way without the prior written permission of the copyright owner. Such permission, if granted, is subject to a fee depending on the nature of the use. Requests and inquiries regarding reproduction should be addressed to the Copyright Owner. Any unauthorized reproduction, publication, transmission, adaptation of this drawing or design is an act of copyright infringement which will render the doer of the act liable for civil law copyright infringement and may in certain circumstances render the doer liable to criminal prosecution.

**GENERAL NOTES**

- All dimensions to be thoroughly checked on site and any or all discrepancies to be reported to the author of this drawing immediately before any work is put to hand.
- All work to be executed by competent persons qualified for the specific trade.
- Storm water management as per engineers design & specification.
- All structural and retaining elements to be designed & specified by engineer.
- Plant species may be substituted for a similar species, depending on availability at time of installation.

NO	DATE	REVISION
1	10-11-2023	DESIGN CHANGES
2	10-11-2023	DESIGN CHANGES
3	10-24-2023	PLANT CHANGES

**PRINT NOTICE**  
 Ensure correct page size is selected. (Refer to file name for page size)  
 To ensure correct scale, print "ACTUAL SIZE" do NOT select "FIT TO PAGE".



# LANDSCAPE PLAN - 3 of 3

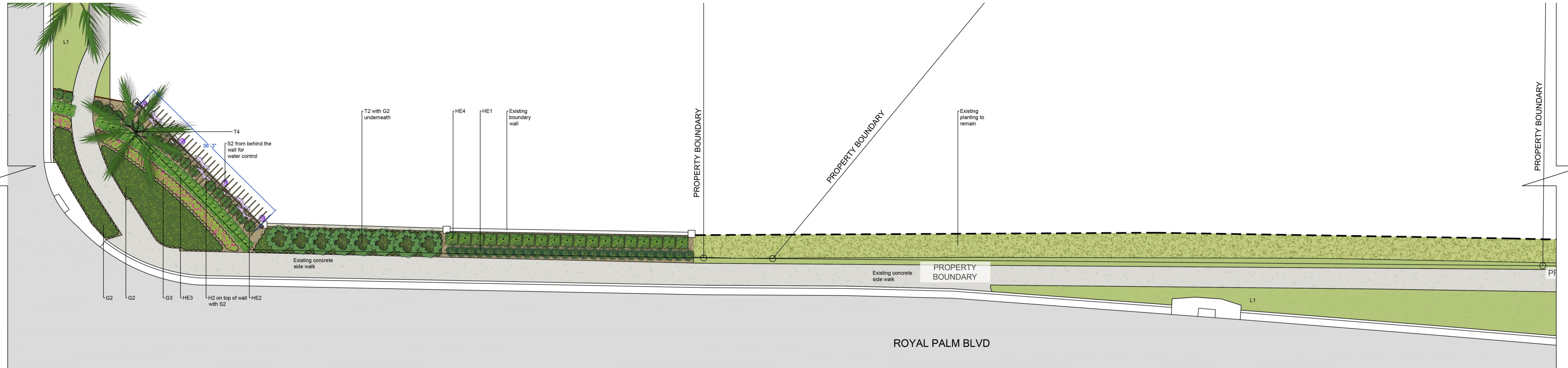

PLAN D - WEST SECTION 1

## ADDISON PROJECT - OPTION 1

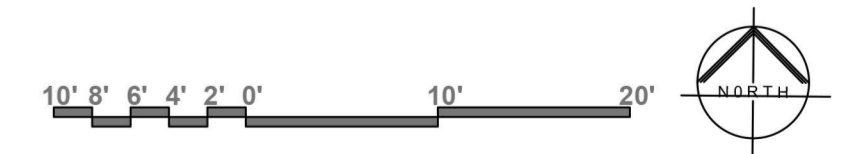

10005 Royal Palm Blvd, Coral Springs, FL 33065 | 10-24-2023 | Scale 1"=10'-0" 24x36in  
 | Designed by: BT | Author: LW | Checked: SR | Rev: 3 | Issued for client feedback

COPYRIGHT NOTICE  
 © Copyright 2023. This drawing & design is subject to copyright. All rights reserved in terms of the United States Copyright Law. You may use, display, print and reproduce this drawing only for use on the project as described in the title block of this drawing. The author of this drawing & design is the copyright owner and it remains the property of the author. No parts of this drawing or design may be reproduced, published, transmitted or adapted in any way without the prior written permission of the copyright owner. Such permission, if granted, is subject to a fee depending on the nature of the use. Requests and inquiries regarding reproduction should be addressed to the Copyright Owner. Any unauthorized reproduction, publication, transmission, adaptation of this drawing or design is an act of copyright infringement which will render the doer of the act liable for civil law copyright infringement and may in certain circumstances render the doer liable to criminal prosecution.

### GENERAL NOTES

- All dimensions to be thoroughly checked on site and any or all discrepancies to be reported to the author of this drawing immediately before any work is put to hand.
- All work to be executed by competent persons qualified for the specific trade.
- Storm water management as per engineers design & specification.
- All structural and retaining elements to be designed & specified by engineer.
- Plant species may be substituted for a similar species, depending on availability at time of installation.

NO	DATE	REVISION
1	10-11-2023	DESIGN CHANGES
2	10-11-2023	DESIGN CHANGES
3	10-24-2023	PLANT CHANGES

PRINT NOTICE  
 Ensure correct page size is selected. (Refer to file name for page size)  
 To ensure correct scale, print "ACTUAL SIZE" do NOT select "FIT TO PAGE".

